

Firmennachrichten

## **DOS SANTOS INTERNATIONAL to Supply High Angle Conveyors for Buritica Project**

Bearbeitet von am 23. Aug. 2017  
*Marietta (GA), Vereinigte Staaten –*

Buritica is approximately a two-hour drive on the paved, Pan-American highway from Medellín, Colombia's second largest city. Some highlights of the project are noted below:

- Maiden mineral reserve for the combined Yaraguá and Veta Sur vein systems total 3.7 million ounces of gold and 10.7 million ounces of silver (13.7 million tonnes grading 8.4 g/t gold and 24.3 g/t silver)
- Gold and silver recoveries of 94.1% and 59.9% are expected, respectively, over the life of the mine ("LOM")
- A 14-year mine life will produce 3,492,000 ounces of recovered gold and 6,425,000 ounces of recovered silver

This is the second gold project on which **DSI** has cooperated with **M3 Engineering**. In 2010, **DSI** executed a contract through **M3** for an overland conveyor system at **Goldcorp's** Los Filos Project in the Nukay mining district of central Guerrero State in Southern Mexico.

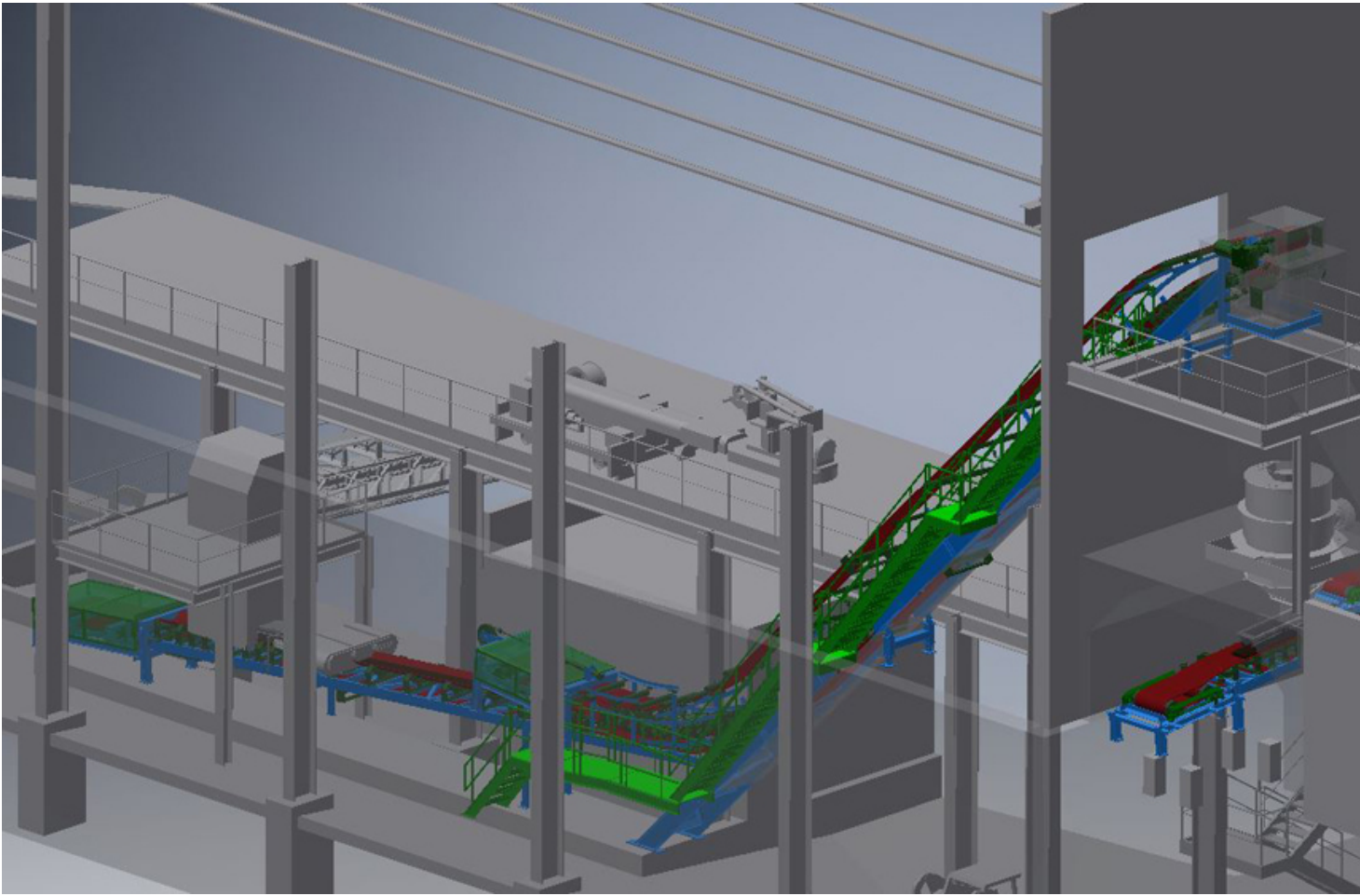

The DSI Sandwich high angle conveyors will serve as transfer conveyors elevating crushed pebble ore, each at a rate of 135 t/h and a 45° incline for Continental Gold's Buriticá project in Antioquia, Columbia.

**DSI** Sandwich belt high angle conveyors take on many forms and offer many advantages. Each **DSI** Sandwich Conveyor uses two standard, smooth-surfaced conveyor belts, face-to-face, to gently but firmly contain the product being carried. This not only makes steep angles possible; it also offers a spillage free, environmentally sound operation because the material remains secured between the belts. A **DSI** sandwich conveyor is capable of higher conveying speeds and greater capacities than other high angle conveying methods. With the availability of wider belts and accompanying hardware, capacities greater than 10,000 t/h can be easily achieved with a **DSI** Sandwich conveyor. High angles of 90° are typical, and lifts of 300m are easily accomplished. The use of all conventional conveyor parts ensures high availability and low maintenance costs, as well as interchangeability of components and fast delivery of replacement parts. [Dos Santos International](#) is the world's foremost authority on sandwich belt high angle conveyors. The company was founded and is currently led by the inventor

of the system, **Joseph Dos Santos**. DSI is known for its extensive worldwide experience in sales, engineering, and construction of bulk materials handling systems and equipment. This has included major contributions that have expanded the range of bulk handling and transport solutions. Most notably advances in sandwich belt high angle conveyors have led to their worldwide utilization. The expertise of DSI spans a wide range of materials handling systems and equipment including high angle conveyors, high powered, high capacity, high lift slope conveyors and long overland conveyors utilizing the very latest technology. To learn more about **Dos Santos International** and their most reliable and economical solution for your steep angle and vertical high-tonnage conveying requirements, visit <http://edir.bulk-online.com/profile/1140-dos-santos-international.html>